

TOWNSHIP OF MADAWASKA VALLEY ZONING BY-LAW
SCHEDULE "A" (Map 4)
(North Half of the Geographic Township of Sherwood)

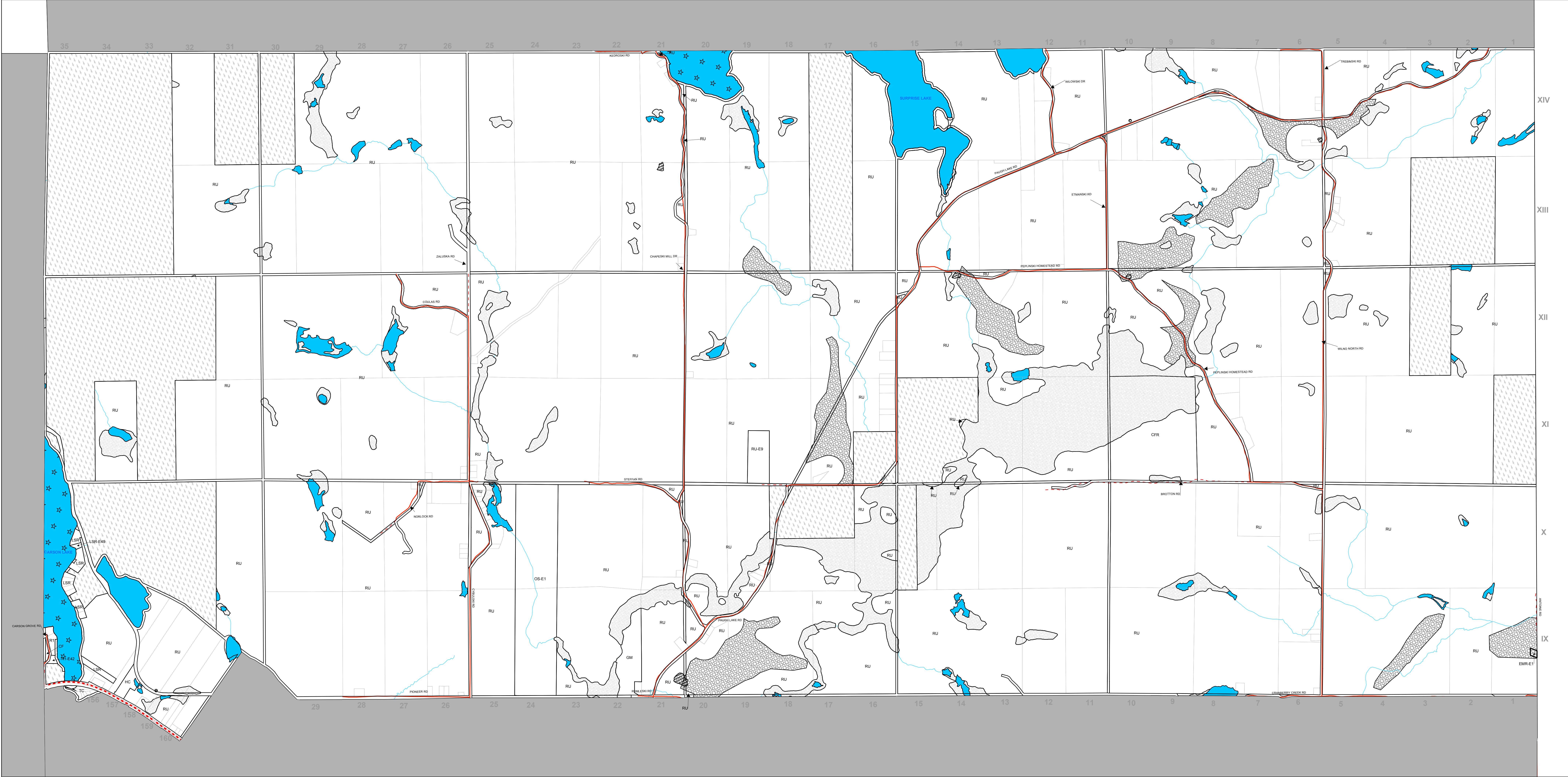

- R1 Residential One
- R2 Residential Two
- LSR Limited Service Residential
- SR Seasonal Residential
- C Commercial
- HC Highway Commercial
- TC Tourism Commercial
- GM General Industrial
- DM1 Disposal Industrial One
- DM2 Disposal Industrial Two
- RU Rural
- CF Community Facility
- OS Open Space
- SUR Suburban Reserve
- h Holding Zone

- E1 Exception One (Numbered consecutively for each respective zone classification e.g. RU-E1, RU-E2, etc.)
- CFR County Forest
- Crown
- Flooded Area
- Environmental Protection (EP)
- Extractive Industrial (EM)
- Extractive Industrial Reserve (EMR)
- Provincially Significant Wetlands (PSW)
- Areas of Natural and Scientific Interest (ANSI)
- Open Water
- Sensitive Lake
- Active Waste Disposal Site on Crown Land
- Inactive Waste Disposal Site
- Water Course
- County Road
- Provincial Road
- Municipal Maintained Year-Round Road
- Municipal Seasonally Maintained

This is Schedule "A" to By-Law No. 2006-26
Passed the 1st day of MAY, 2006.

Signatures of the Signing Officers:

[Signature] Reeve
[Signature] CAO/Clerk

[Signature]
Dennis D. Carter
ACTING CHAIRPERSON

Map Consolidation Date
Housekeeping Bylaw Consolidation - May 2, 2011
June 4, 2018

